

## ⚠ IMPORTANT SAFETY WARNING

Before proceeding with the installation of your van kits, please read and understand the following safety instructions. Failure to follow these guidelines may result in personal injury, property damage, or other hazards. By installing this kit, you acknowledge and accept all associated risks.

1. This installation is intended to be completed with two people, or with the use of third-arm tools. Before starting the installation, ensure that the van is parked on a level surface.
2. Use the correct tools and equipment as specified in the instruction manual. Failure to use the proper tools may result in damage to the wood or van.
3. Ensure that the installation is properly secured to the van's interior structure. Failure to do so may result in instability and potential falling/tipping hazards while driving.

Disclaimer: This manual provides general guidelines for van installation. However, individual van configurations may vary. It is your responsibility to assess your specific situation and make informed decisions. Timber Van Kits and its affiliates cannot be held liable for any accidents, injuries, or damages resulting from improper installation, misuse, or neglect.

# TIMBER

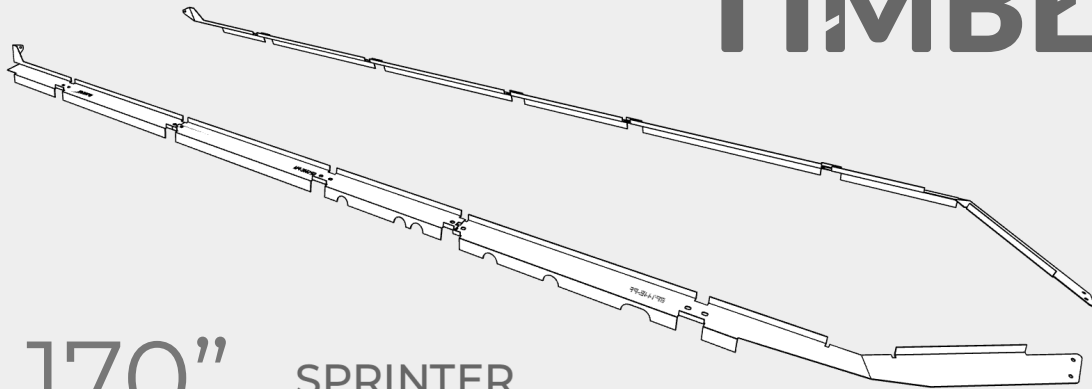

## 170" SPRINTER CORNER STRUCTURE

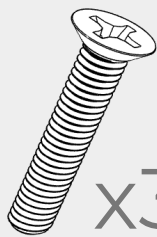
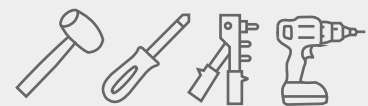

x34

FAS364

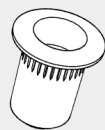

x34

FAS001



x6

FAS302

1

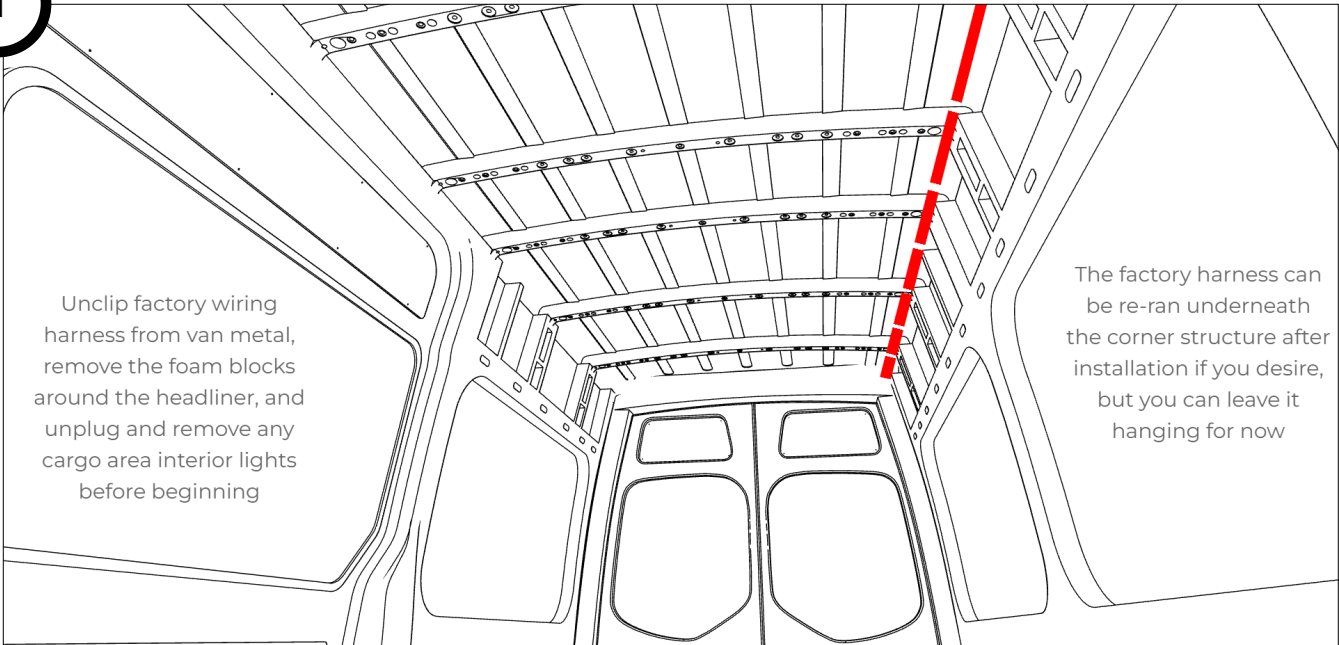

Unclip factory wiring harness from van metal, remove the foam blocks around the headliner, and unplug and remove any cargo area interior lights before beginning

The factory harness can be re-ran underneath the corner structure after installation if you desire, but you can leave it hanging for now

2

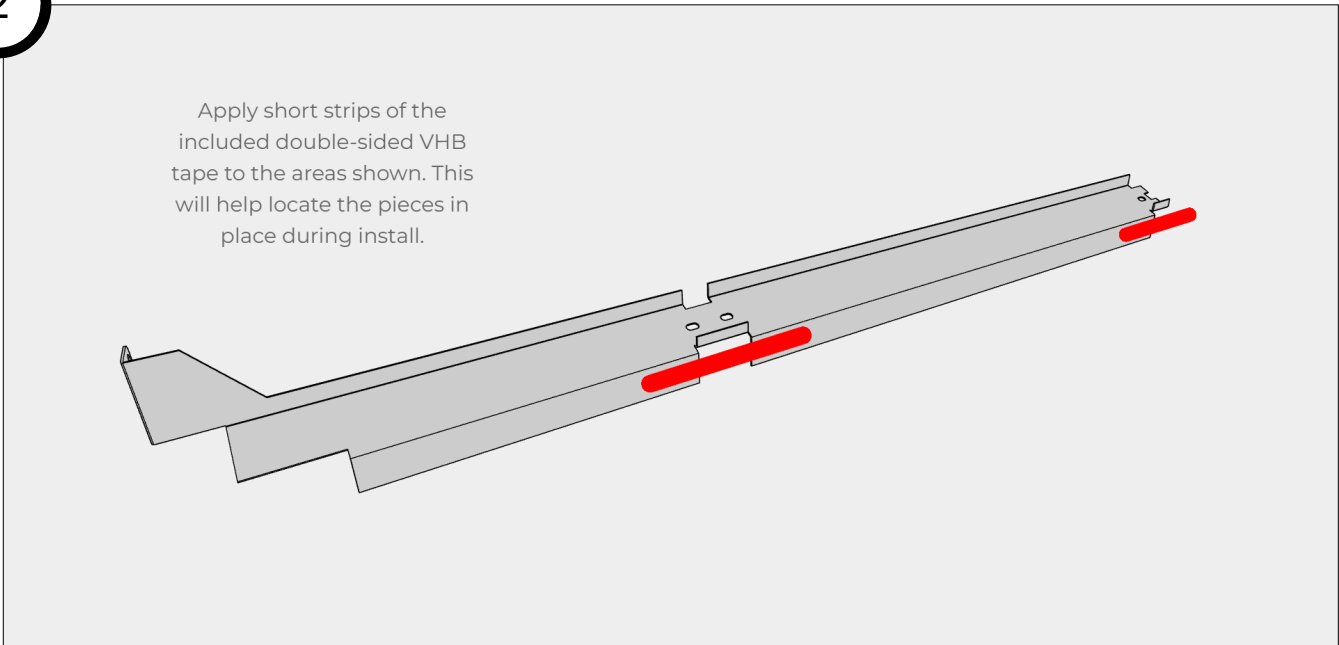

Apply short strips of the included double-sided VHB tape to the areas shown. This will help locate the pieces in place during install.

3

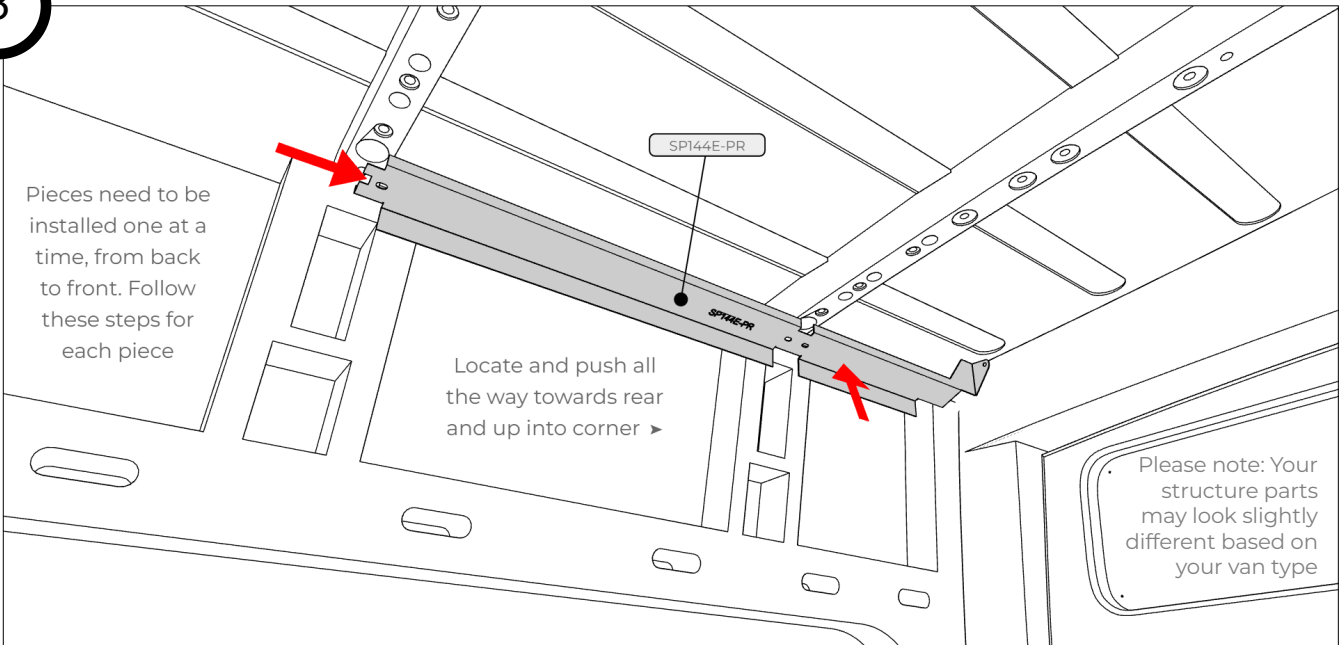

Pieces need to be installed one at a time, from back to front. Follow these steps for each piece

Locate and push all the way towards rear and up into corner ▶

Please note: Your structure parts may look slightly different based on your van type

4

Locating the holes is an important step, take your time and double check your punch locations are in the center of the slots

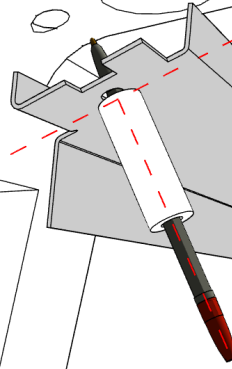

Mark all 4 holes with the included center punch and a hammer, Using the tube as a guide

5

After you've verified the center punches line up with the slots, use the provided drill bit and the same tube guide to drill out each hole

19/64"  
Drill Bit

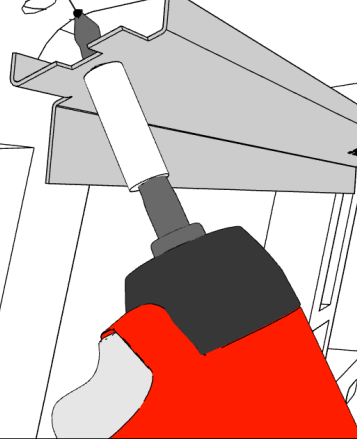

6

Pull the structure piece down for this step. Hex rivnuts should be tight to insert in the holes, we recommend pre-threading the rivnut on the rivet gun and lightly tapping the back to get it flush against the van metal before crimping.

4X



7

Set the rivnuts with your choice of tool, using a 10-32 thread attachment. Go slow and make sure to keep the rivnut flush against the van metal while installing.

It's very easy to over-tighten and ruin the threads if you're using a manual hand tool. Only go until you feel a slight resistance

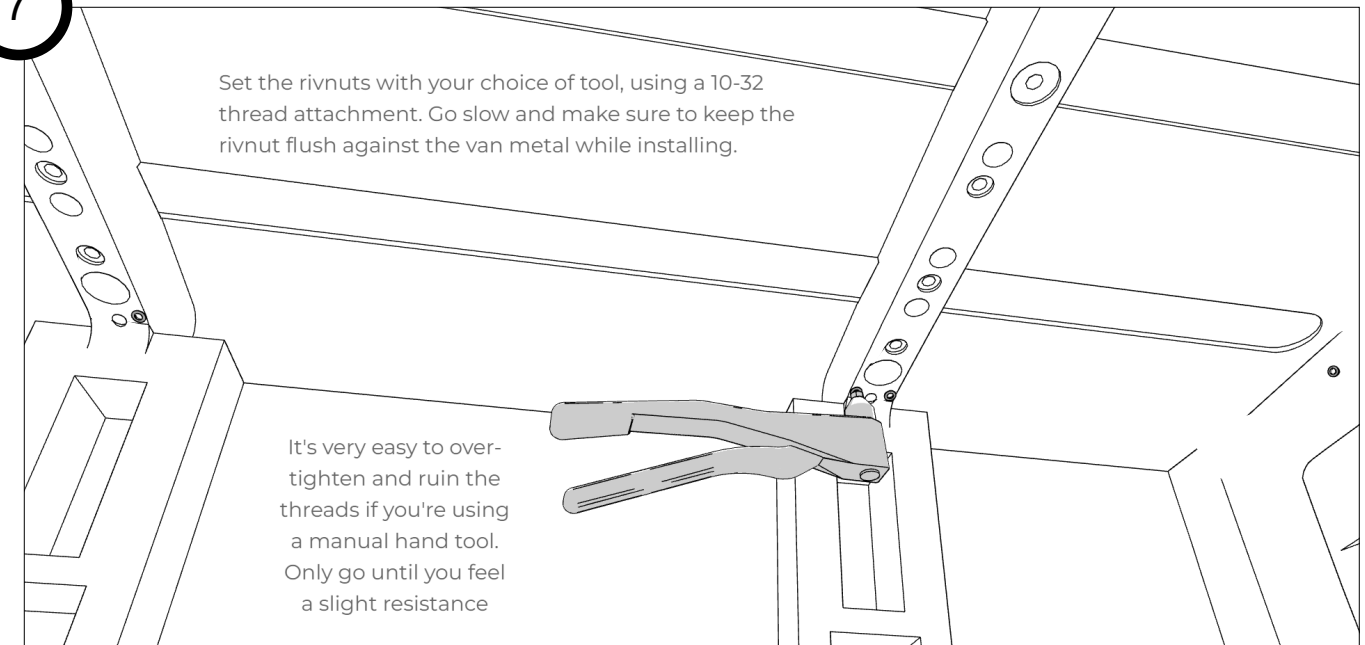

8

4X

SPT14AE-PR

Hand install all screws with a screwdriver to avoid spinning rivnuts. Screws should thread in easily, if you're feeling resistance don't try to force the screw as you will spin out the rivnut. This issue could be a result of overtightening in the previous step, we'd recommend drilling out the outer flange and installing a fresh one.

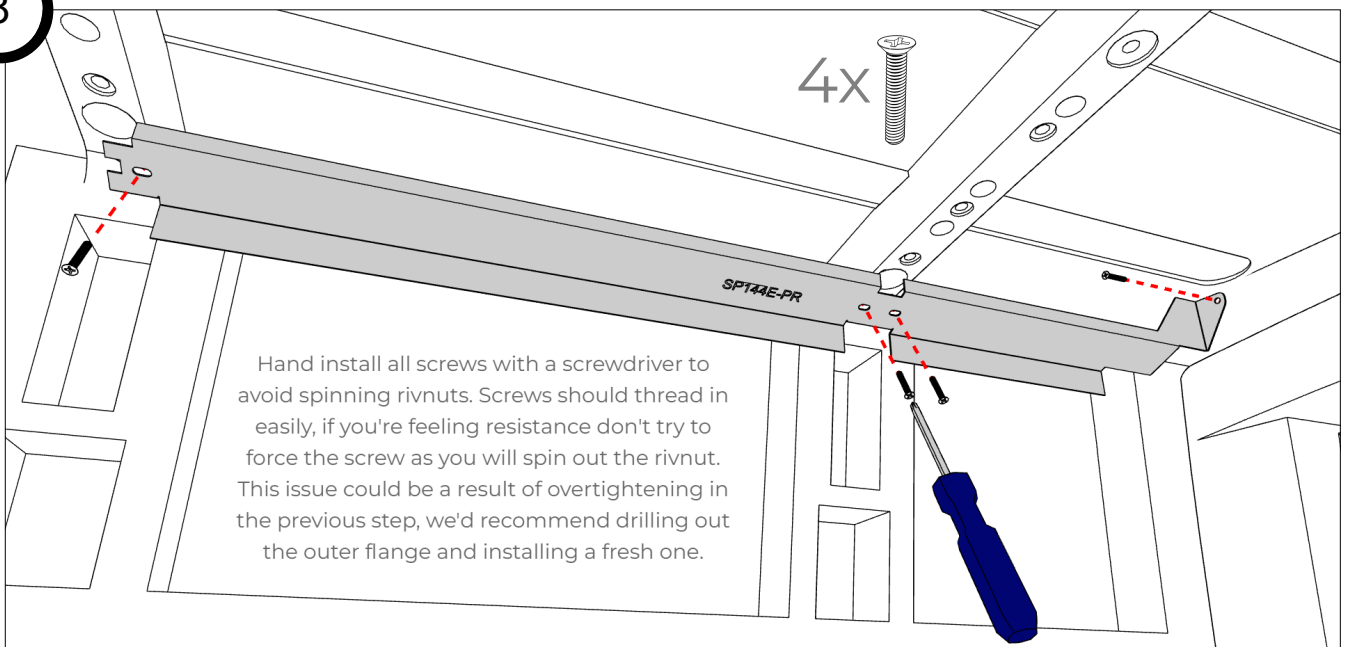

9

Proper alignment is key for this install. You can slightly adjust off center rivnuts by inserting a screw and tapping LIGHTLY with a hammer

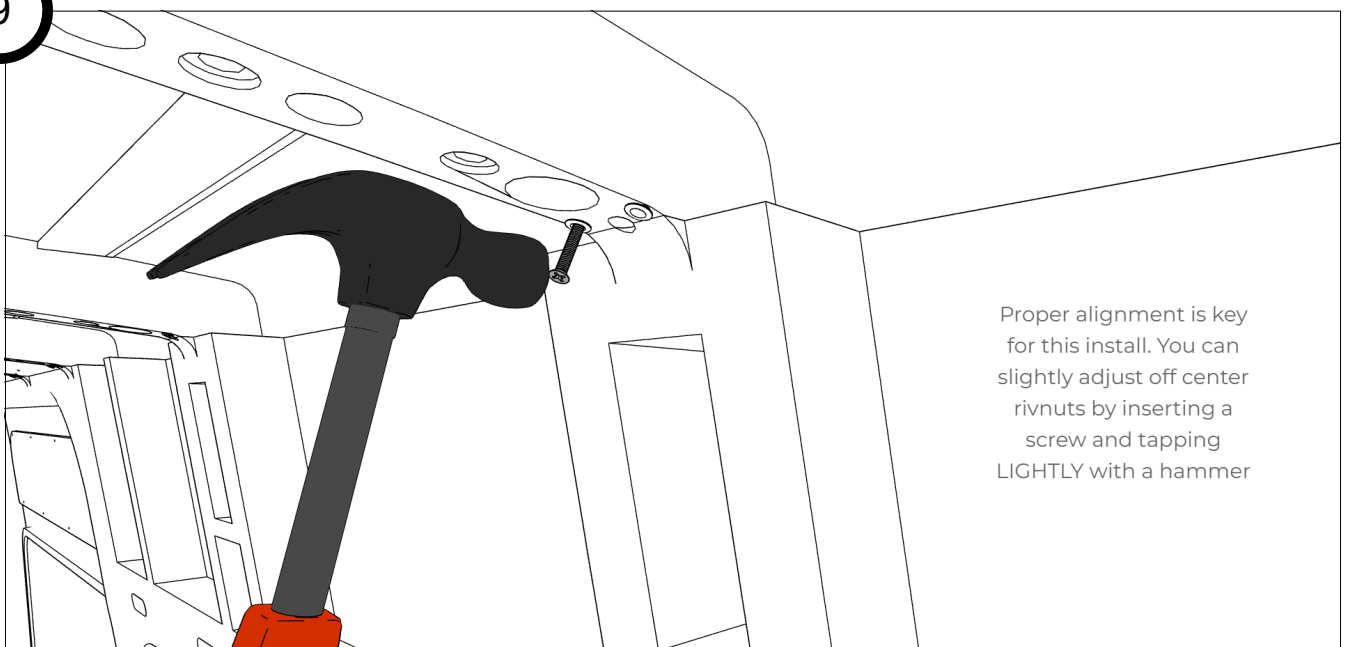

10

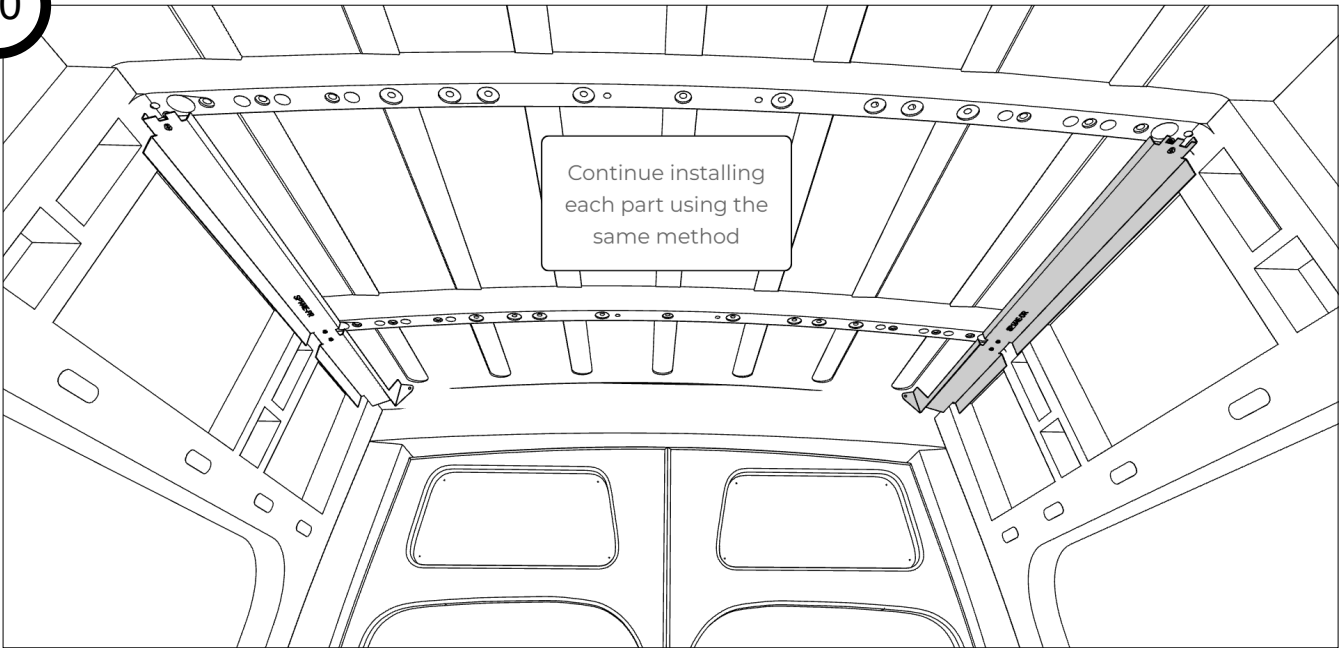

11

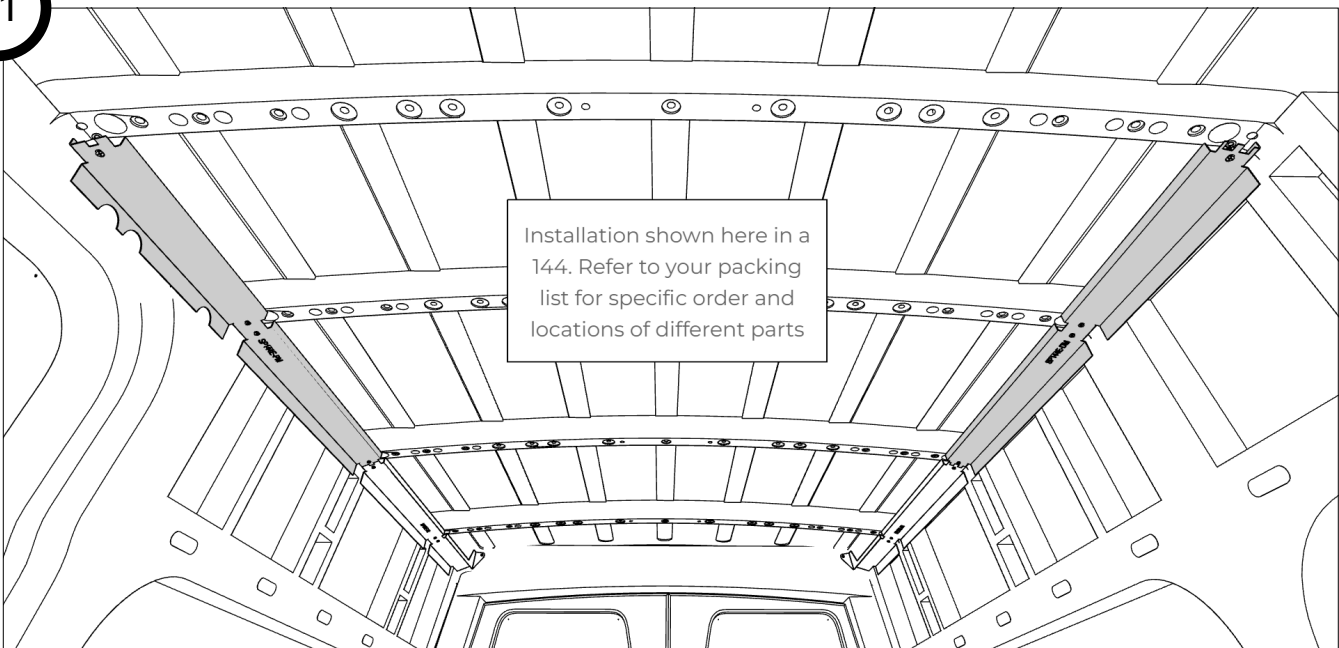

12

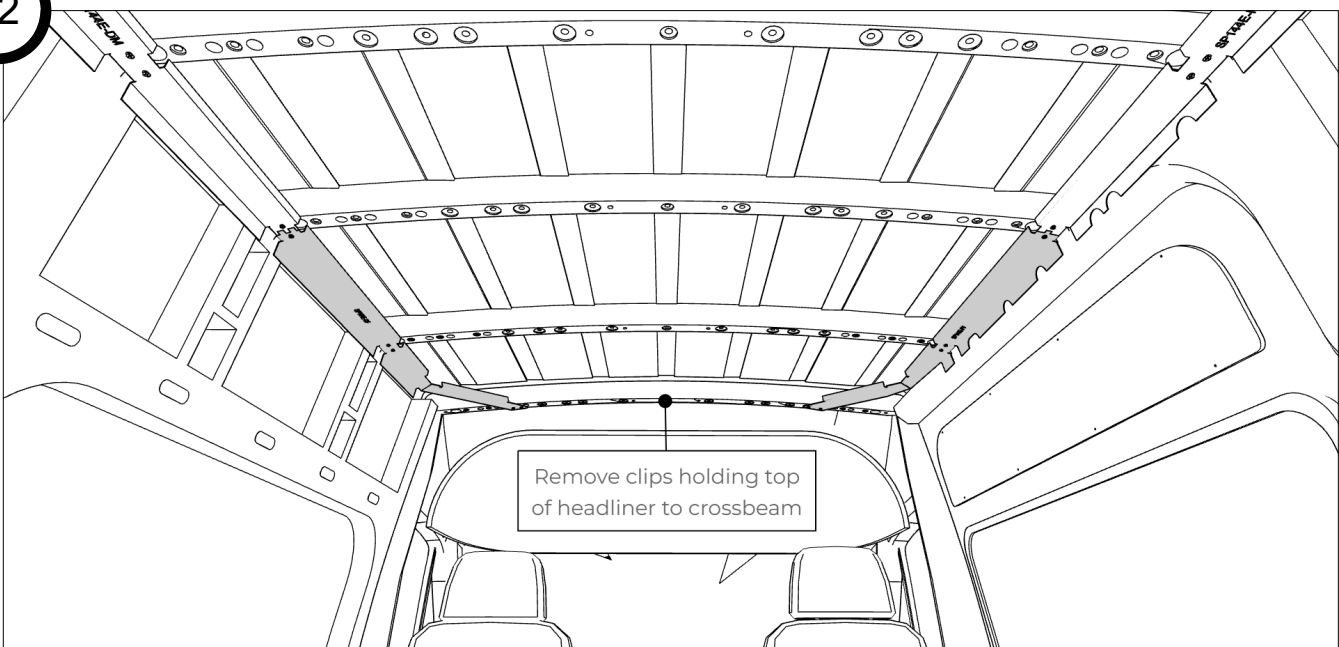

13

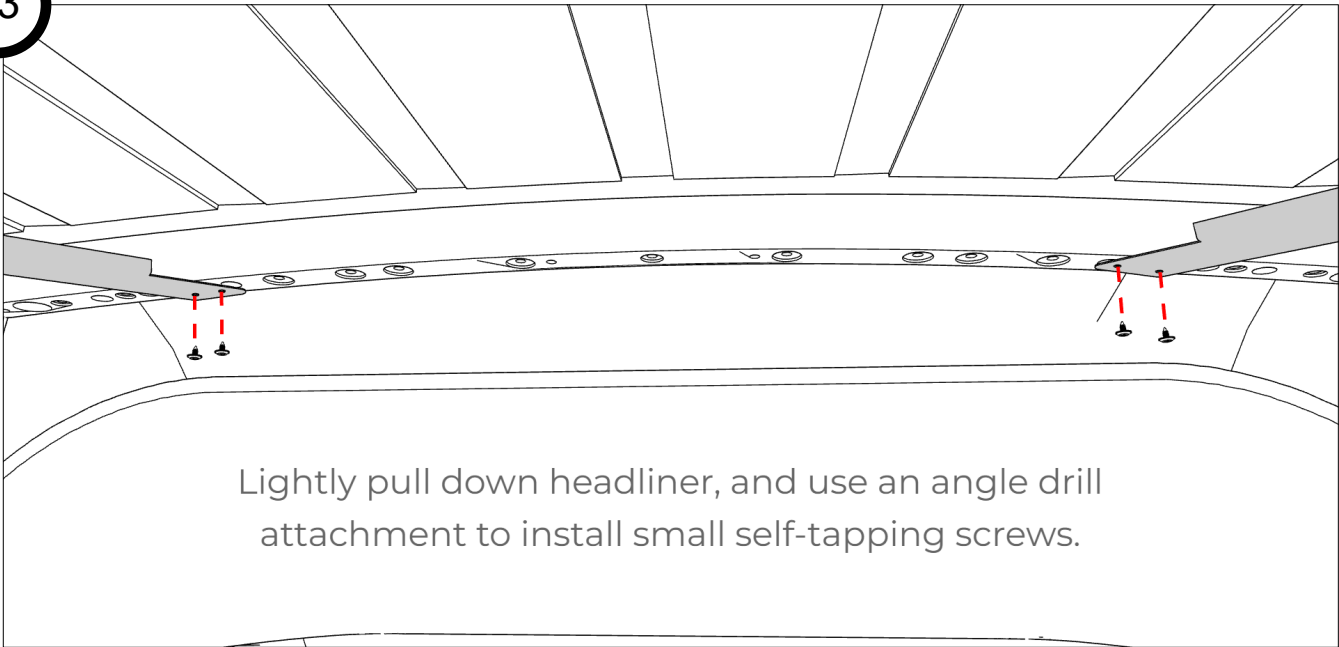

14

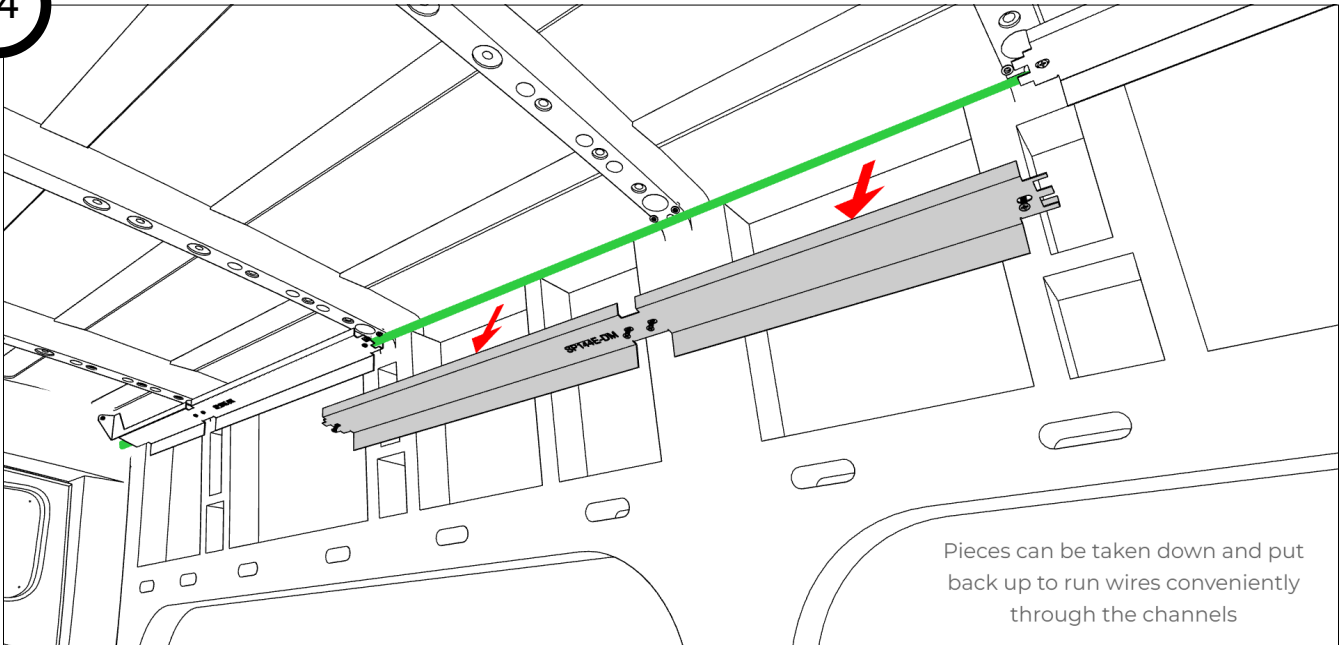

# TIMBER

---

Structure Installation Complete  
Congratulations!



Remember, your journey doesn't end here. We encourage you to explore our panels kits and overhead cabinets that integrate seamlessly with your new structural.

Thank you once again for choosing Timber Van Kits. Your dedication and craftsmanship have brought our product to life, and we look forward to being a part of your future adventures!

---

[TIMBERVANKITS.COM](https://timbervankits.com) • 720-282-5075

Have a question or issues with your product? Feel free to call us or send a message via the [contact page](#) on our website. If you call us and we can't get to the phone please leave us a message and we'll get back to you as soon as we can.

 [facebook.com/timbervankits](https://facebook.com/timbervankits)

 [instagram.com/timbervankits](https://instagram.com/timbervankits)